

17'10" x 20'4"
16 ppl
4 tables of 4

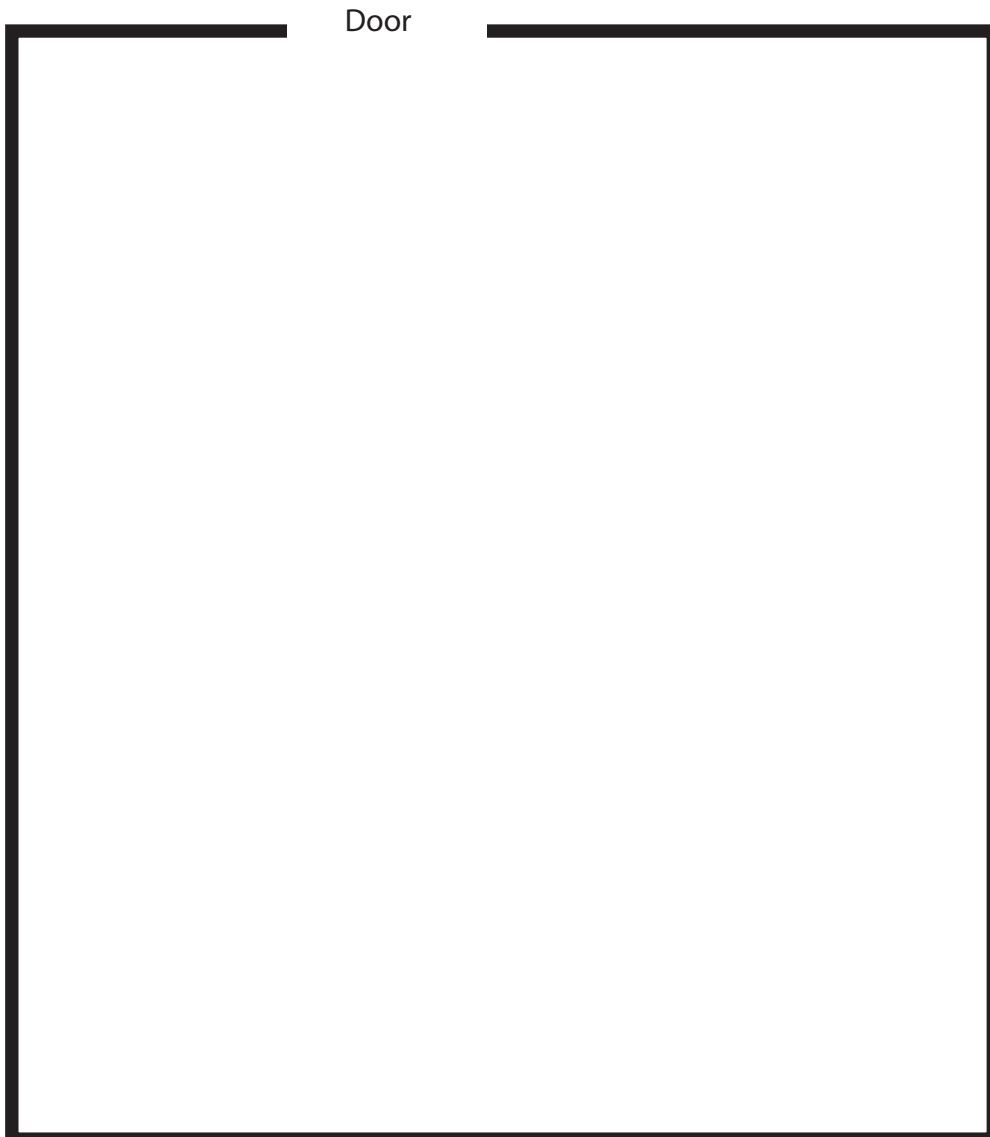

35' x 31'
80 ppl
8 Tables of 10

45 ppl
4 long tables of 10-12



Curtain to main dining room

Upstairs (Last Resort Rom- no working bar/bathroom)

13'8" x 48'4"

Edison Park

No Restroom Upstairs

4 long tables of 8

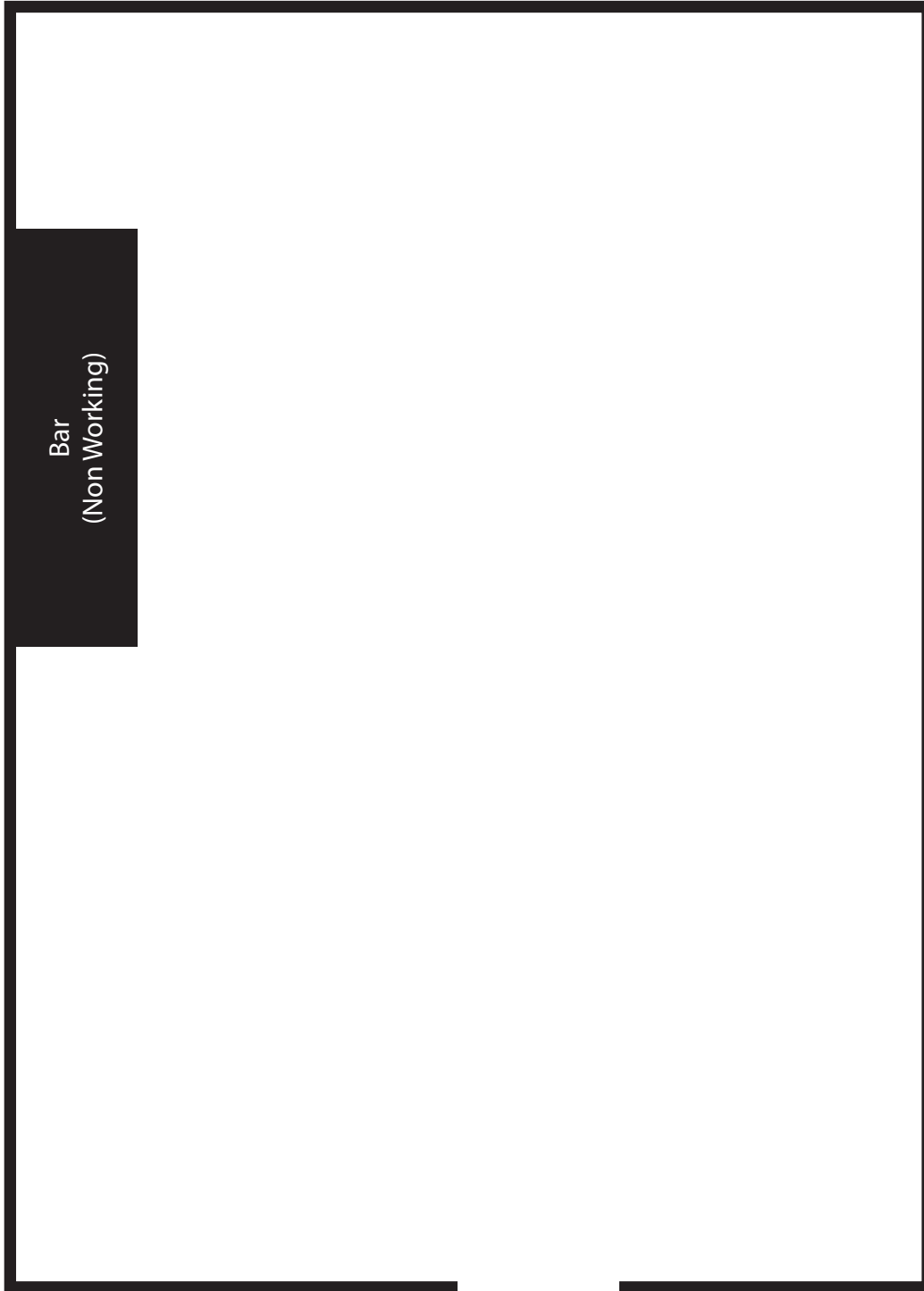

Stairs

Fireside (Not very private)

Edison Park

27'11" x 22'9"

34 ppl

3 long hightops of 6, 4 booths of 4

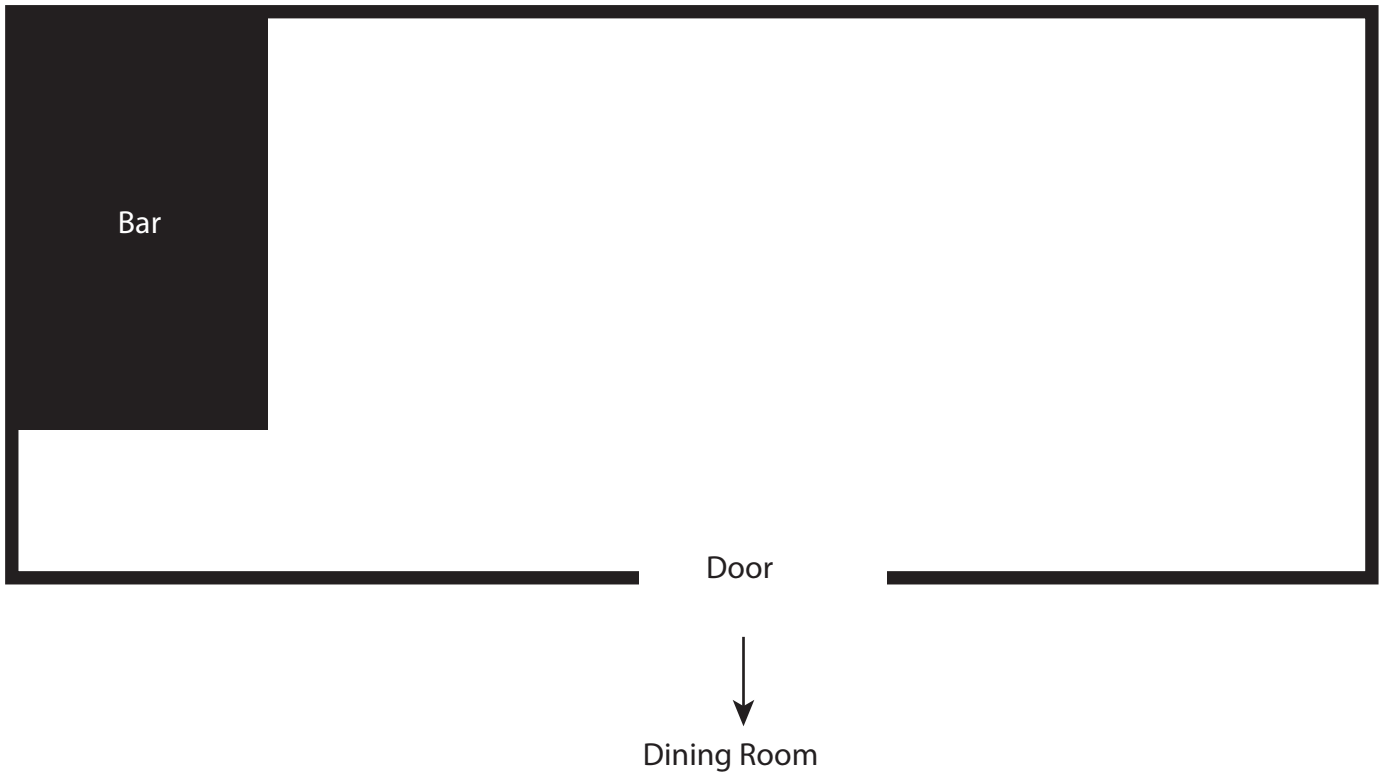

Bar for Reception

55'11" x 33'5"

50 ppl

Reception Only

9 high tops of 4-5

Edison Park

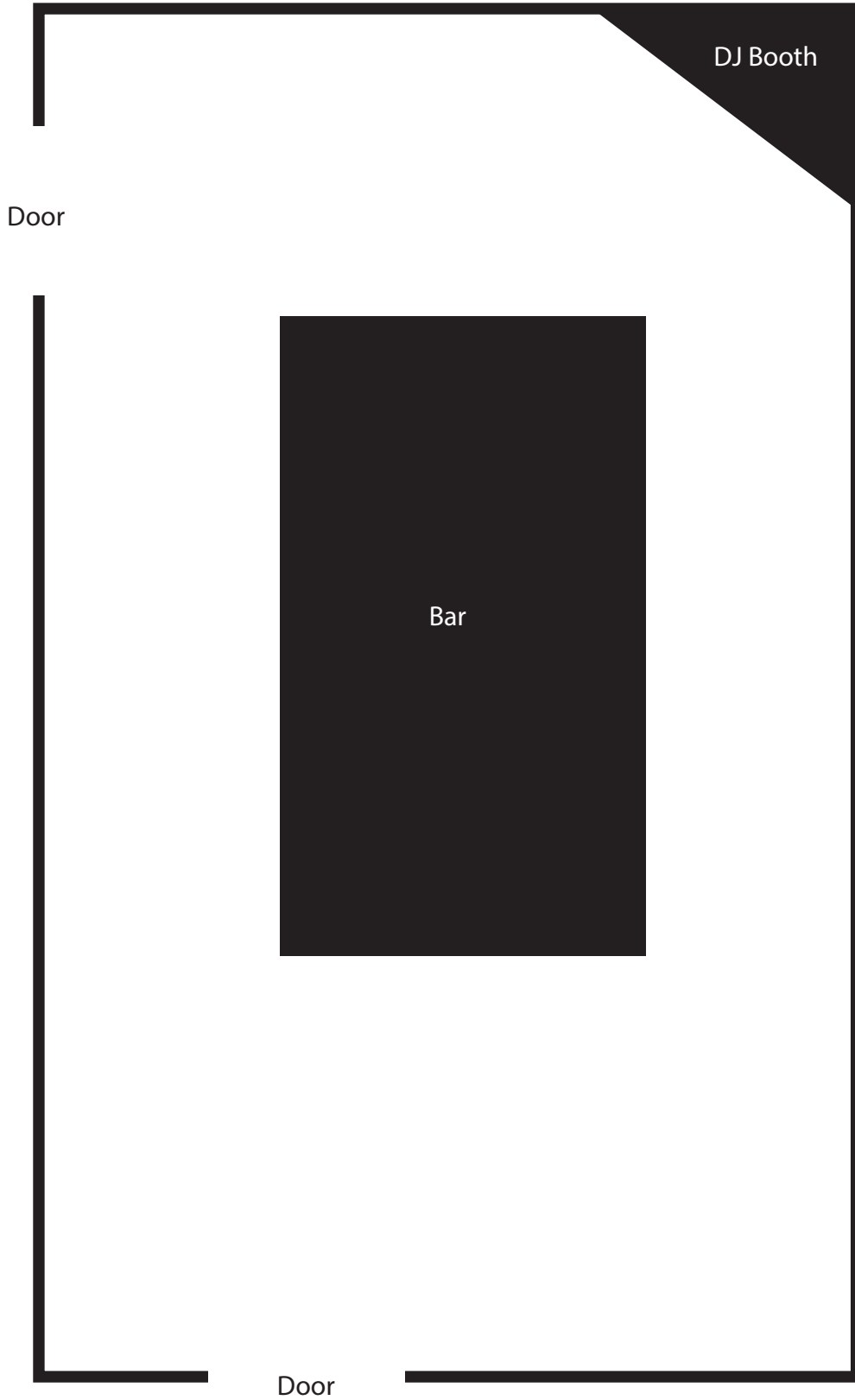

Celebration
106' x 18'5"

Edison Park

Room total: $A+B+C+D=120$???. why does it say 200?

$A+B=30$ or 50 ppl?

$A+B+C=70$ or 90 ppl?

