

Room 1
54'8" x 27'11"

Morton Grove

280 Seats on Patio

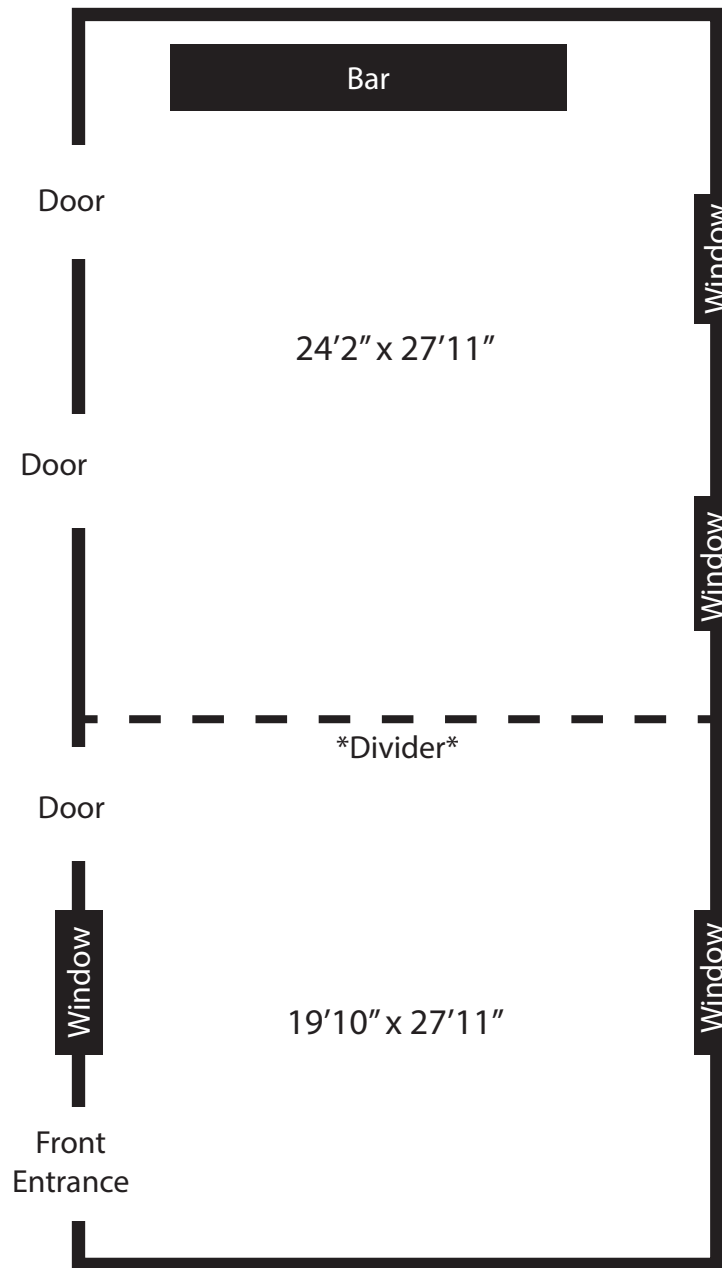

Configuration 1 (With divider)

No Buffet - Nothing But Seating

Max Seating Top Half: 35

5 tables of 8

Max Seating Bottom Half: 30

4 tables of 8

Configuration 2 (No divider)

Max Seating: 90

9 tables of 10

39'3" x 19'3"

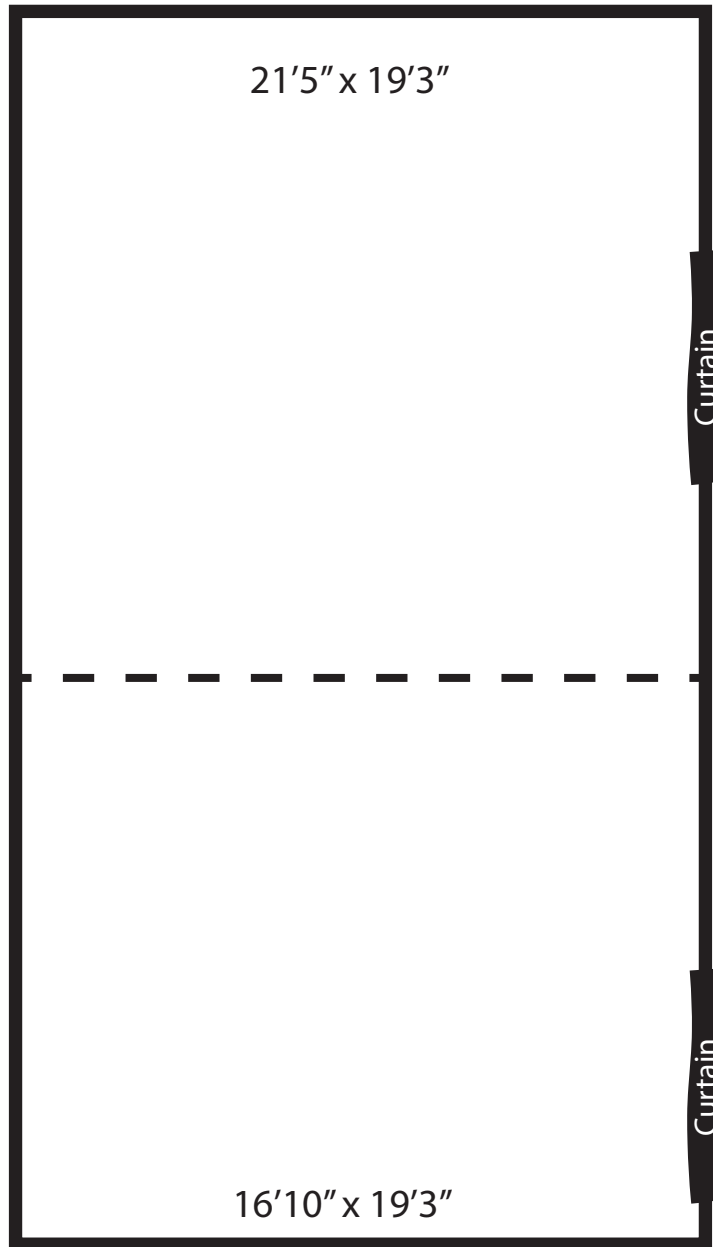

Configuration 1 (With divider)

Max Seating Top Half: 25

3 tables of 8

Max Seating Bottom Half: 25

3 tables of 8

Configuration 1 (No divider)

Max Seating 60

6 tables of 10